

For Sale

- 15 Brady Drive, Hudson, New Hampshire 03051

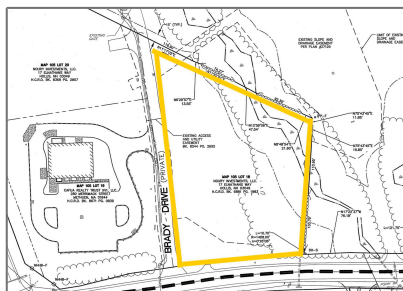

Basic Info

Property Type:

Listing Type: **For Sale**

Price: **\$575,000**

Lot Area: **2.20 Acre**

MLS #: **4881135**

Days On Market: **844**

Property Details

Listing Status: **Active**

Tax - Gross Amount: **\$4,885**

Tax Year: **2020**

Garage Capacity: **0**

Zoning: **G-1**

Lot - Sqft: **95,832 Sqft**

Road Frontage: **Yes**

Price Per SQFT: **\$0**

Easements: **Yes**

Location

Address: **15 Brady Drive**

County: **NH-Hillsborough**

Country: **US**

State: **NH**

City: **Hudson**

Zipcode: **03051**

Flood Zone: **No**

Directions: **Head East on 102
From Hudson, Lot**

Exterior

Water Frontage Length: **0**

**is on corner of
Brady Dr and
Robinson Rd off
Rt.102. Next To
Dunkin Donuts and
Storage Facility.**

Room [Details](#)

Sale Includes:	Land Only
----------------	------------------

Utilities

Sewer:	Private
--------	----------------

Water:	Public
--------	---------------

Utilities:	Cable - Available, Gas - At Street
------------	---

Listing [Info](#)

Listing Agent First Name:	Tiffany
------------------------------	----------------

Listing Agent Last Name:	Peret
-----------------------------	--------------

Listing Office:	Keller Williams Gateway Realty
-----------------	---

Agent [Info](#)



Cowan & Zellers

✉ info@cowanandzellers.com

603-225-3333 - 30 South Main Street

