

For Sale

- Patten Hill Road, Hillsborough, New Hampshire
03244

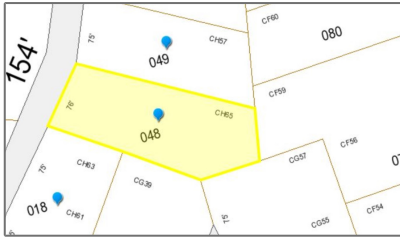

Basic Info

| | |
|-----------------|------------------|
| Property Type: | |
| Listing Type: | For Sale |
| Price: | \$15,500 |
| Lot Area: | 0.33 Acre |
| MLS #: | 4855151 |
| Days On Market: | 1019 |

Property Details

| | |
|----------------------------|---------------------------------|
| Listing Status: | Active |
| Tax - Gross Amount: | \$1,600 |
| Tax Year: | 2020 |
| Garage Capacity: | 0 |
| Zoning: | RES |
| Roads: | Association |
| Lot - Sqft: | 14,375 Sqft |
| Road Frontage: | Yes |
| Price Per SQFT: | \$46,970 |
| Road Frontage Length: | 76 |
| Easements: | Unknown |
| Development / Subdivision: | Emerald Lake Association |

Location

| | |
|----------|-------------------------|
| Address: | Patten Hill Road |
| County: | NH-Hillsborough |
| Country: | US |
| State: | NH |
| City: | Hillsborough |

Exterior

| | |
|--------------------------|--------------------------------------|
| Water Body Restrictions: | Unknown |
| Water Body Type: | Lake |
| Water Body Name: | Gould Pond (AKA Emerald Lake) |

Zipcode: **03244**

Flood Zone: **Unknown**

Water Frontage Length: **0**

Lot Description: **Level**

Room [Details](#)

Unit/Lot #: **48**

Utilities

Sewer: **On-Site Septic Needed**

Water: **On-Site Well Needed**

Electric: **At Street**

Utilities: **None**

Listing [Info](#)

Listing Agent First Name: **Patricia**

Listing Agent Last Name: **McLaughlin**

Listing Office: **PJMrealestate.com**

Agent [Info](#)



Cowan & Zellers

✉ info@cowanandzellers.com

603-225-3333 - 30 South Main Street

