

Single Family For Sale

9,990 Sqft - 70 Shipwright Way, Newington, New Hampshire 03801

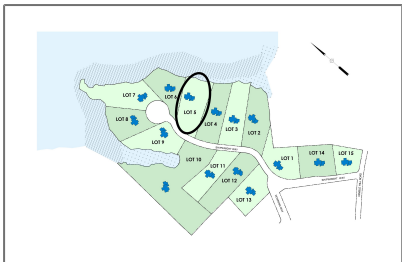
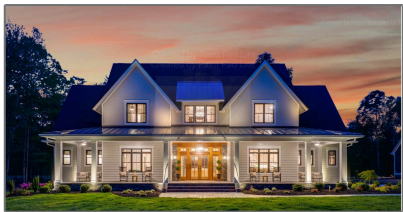

Basic Info

Property Type:	Single Family
Listing Type:	For Sale
Price:	\$3,665,000
Bedrooms:	4
Baths Total:	6
Full Bathrooms:	5
Half Bathrooms:	1
Lot Area:	2.02 Acre
Square Footage:	9,990 Sqft
Year Built:	2024
MLS #:	4988784
Days On Market:	35

Location

Address:	70 Shipwright Way
County:	NH-Rockingham
Country:	US
State:	NH

Property Details

Listing Status:	Active
Garage:	Yes
Tax - Gross Amount:	\$0
Garage Capacity:	3
Zoning:	Residential
Roads:	Cul-de-Sac
Lot - Sqft:	87,991 Sqft
Road Frontage:	Yes
Price Per SQFT:	\$734
Road Frontage Length:	225
Easements:	Yes
Development / Subdivision:	Shackford Point Estates

Exterior

Waterfront:	Yes
Foundation:	Poured Concrete
Roof:	Metal, Shingle - Architectural, Shingle - Asphalt

City:	Newington
Zipcode:	03801
School - Elementary:	New Franklin School
School - Middle/Jr:	Portsmouth Middle School
School - High:	Portsmouth High School
Flood Zone:	No
Directions:	95 to Exit 4. Right on Nimble Hill Rd to Shipwright Way

Interior

Flooring: **Carpet,Ceramic Tile,Hardwood**

Basement Description: **Unfinished**

Features - Interior: **Cathedral Ceiling,Dining Area,Fireplace - Gas,Hearth,Kitchen Island,Laundry Hook-ups,Primary BR w/ BA,Soaking Tub,Walk-in Closet,Walk-in Pantry,Laundry - 2nd Floor**

Utilities

Sewer: **Private**

Heating System: **Gas Heater - Vented**

Cooling System: **Central Ac**

Electric: **Underground**

Heat Fuel: **Gas - Natural**

Utilities: **Gas - At Street**

Construction Status: **New Construction**

Water Body Restrictions: **Unknown**

Water Body Type: **River**

Water Body Name: **Piscataqua River**

Water Frontage Length: **220**

Features - Exterior: **Deck,Patio,Pool - In Ground,Porch - Covered,Windows - Double Pane**

Driveway: **Paved**

Room Details

Unit/Lot #: **5**

Baths - 1/4: **0**

Baths - 3/4: **0**

Listing Info

Listing Agent First Name: **Adam**

Listing Agent Last Name: **Dow**

Listing Office: **KW Coastal and Lakes & Mountains Realty/Wolfeb**

Agent [Info](#)



Cowan & Zellers

✉ info@cowanandzellers.com

603-225-3333 - 30 South Main Street

